



TK20

**PROFILE LINE FOR
AUTOMATIC ENTRANCES**
WITH REDUCED SECTION
OF 20 MM

FAAC
Simply automatic.

TK 20

TK20 PROFILES

Profile line for automatic entrances with reduced section of 20 mm.

Slender, light, easy to use while respecting legal standards are the features of these new profiles made to add a refined and innovative design to the advantages of an automatic sliding entrance.

Thanks to their simple construction, this series of profiles and seals, can be machined by just using one cropper and other common utensils. This characteristic will make things easy for all customers looking to make automatic entrances where nothing is left to chance and, at the same time, it is appreciated for the quality of the supplied article.

The FAAC cutting configuration file, coupled to the technical drawings, will enable the installer to make, in simple small steps, a cutting list of all the profiles and seals making up the entrance. The configurator also supplies the dimensions of the glass panels.

The assembly manual will enable the correct installation procedure.

DISEGNI / DRAWINGS nr. 02 - 02A - 02B 930/940/A100COMPACT		Disegni Drawing
Nr° Ante Mobili / Nr. Sliding Doors	1	
Nr° Ante Fisse / Nr. Fixed Doors	0	
Soluzione (vedi disegni) / Solution (see drawings)	A	
Tipo Motorizzazione / Motorization type	930N SF	Peso anta (kg.) - Door weight - 46
Nr° Pezzi / Nr. Pieces	1	
LVM Luce Vano Muro (mm.) / Wall Width	1000	
LVP Luce Vano Passaggio (mm.) / Free Passage Width	990	
HVM Altezza Vano Muro (mm.) / Wall Height = altezza sotto carter traversa / height below motorization	2200	
HVP Altezza Vano Passaggio (mm.) / Free Passage Height	2198	
Spessore vetro (mm.) / Glass thickness	8	
Distinta di taglio profili / Cutting profiles list		

COMPILARE GLI SPAZI COLORATI DI GIALLO
PLEASE FILL THE YELLOW COLOURED FIELDS

N.B.: con pesi superiori a 120 kg. (930N SF) per anta singola, si consiglia di utilizzare la motorizzazione tipo 940 SM. Limite utilizzo A100COMPACT: 110 kg.
- PLEASE NOTE: if single door weight exceeds than kgs. 120 (930N SF), we suggest to use

Descrizione / Description	Codice / Code	Quantità / Quantity	Misura / Measure (mm.)	Taglio / Cutting angles	Orientamento / Assembly direction	Disegno / Drawing
Profilo verticale portafotocellule per fissaggio a muro / Fixing wall vertical profile with photoelectric cell	105804	2	2219	90°-90°	verticale vertical	
		1	996	90°-90°	orizzontale horizontal	
Profilo verticale battuta anta singola / Vertical profile for single door locking	105809	1	2219	90°-90°	verticale vertical	
Telaio di fissaggio a muro anta fissa / Fixing wall frame for fixed door	105808					
Profilo verticale per anta mobile asolato e forato / Vertical profile for sliding door	105801	2	2211	90°-90°	verticale vertical	
Profilo verticale per anta fissa asolato e forato / Vertical profile for fixed door	105802					
Traverso superiore / Upper door profile	105805	1	966	90°-90°	orizzontale horizontal	
Traverso inferiore / Lower door profile	105806	1	966	90°-90°	orizzontale horizontal	

Distinta accessori / Accessories list

Descrizione / Description	Codice / Code	Quantità / Quantity	Misura / Measure (mm.)	Taglio / Cutting angles	Orientamento / Assembly direction	Disegno / Drawing
Guarnizione per vetro da 8 mm. (4+4) - 8 (4+4) mm. thickness glass gasket -	105811	1	6194	90°-90°	sui 4 lati on the 4 sides	
Guarnizione di tenuta laterale / Side holding gasket	105812	1	2216	90°-90°	verticale vertical	
Guarnizione di tenuta centrale anta mobile / Sliding door central holding gasket	105813	1	2216	90°-90°	verticale vertical	
Guarnizione di tenuta centrale / Central holding gasket	105813	1	2224	90°-90°	verticale vertical	
Profilo plastico di guida inferiore anta mobile / Lower sliding plastic profile for sliding door	105814	1	998	90°-90°	orizzontale horizontal	
Profilo plastico per chiusura profilo portafotocellula / Plugging plastic profile for profile with photoelectric cell	105816	2	2219	90°-90°	verticale vertical	
Kit accessori anta mobile / Accessories kit for sliding door	105817	1				
Piastrine per fissaggio carrelli per anta mobile / Small plate for sliding door trucking wheels fixing	105819					
Spazzolino / Brush	105346	1	998	90°-90°	orizzontale horizontal	

Distinta di taglio vetri / Cutting glasses list

Quantità / Quantity	Larghezza / Width (mm.)	Altezza / Height (mm.)	Tipo / Type
1	993	2104	Vetro da 8 mm. (4+4) - 8 (4+4) mm. glass -

ITEM OF SPECIFICATIONS TK20

Aluminium alloy profiles with reduced section, series FAAC TK20, with thickness of 20 mm, width of 25mm, complete with gaskets to house glass panels of a thickness of 8 mm or 10 mm with PVB foil 0.76.

Rubber gaskets are interlock-fitted in the centre of the sliding leaves and on the sides a special gasket is used acting on the fixed leaf vertical side on stroke. Both gaskets improve the thermal insulation of the entrance.

The central uprights of the fixed leaf are 30 mm wide and have a double groove to house the photocell. The groove and the visible wires of the photocells will be closed by a quick-release rigid gasket.

The lower base is 80 mm high and an internal seat houses a special plastic profile with the following functions:

- brush support between leaf and floor for the thermal insulation
- sliding guide of the sliding block made of stainless steel.

A100 VERTICAL SECTION WITH TK20 PROFILES

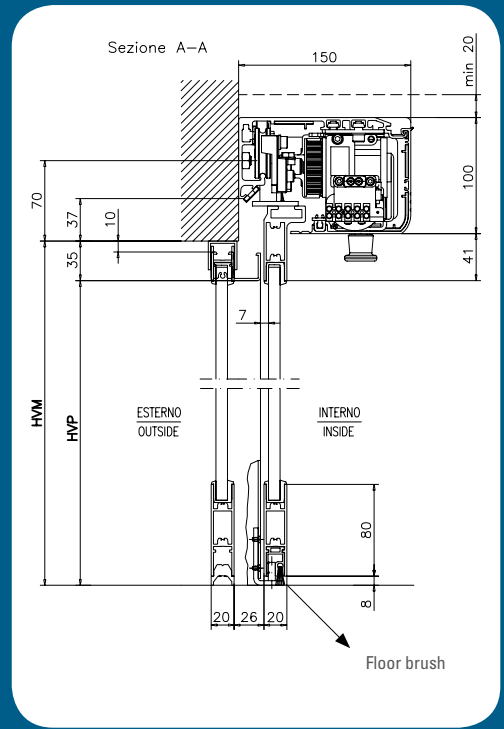

Detail of the striker nodes of mobile and fixed leaves for heat resistance

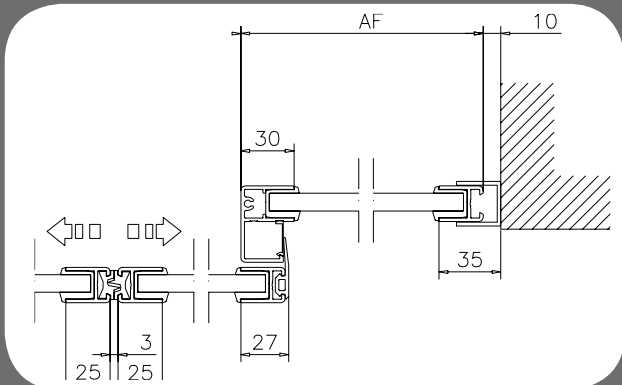

Detail of the different striking systems of sliding leaves if installed in a corridor compartment or in a compartment with edge

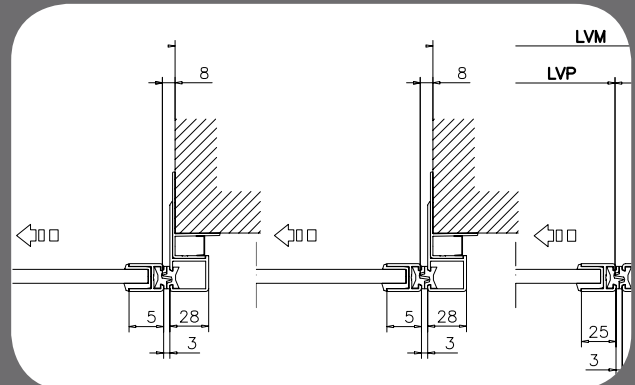

HEADQUARTERS

ITALY

FAAC S.p.A. - Soc. Unipersonale
Via Calari 10 - 40069 Zola Predosa (BO)
Tel. +39 051 61724 - Fax +39 051 758518
it.info@faacgroup.com - www.faacgroup.com

SUBSIDIARIES

ASIA - PACIFIC

FAAC MALAYSIA
MAGNETIC CONTROL SYSTEMS SDN BHD
Selangor, Malaysia
tel. +60 3 5123 0033
www.faac.biz

AUSTRALIA

FAAC AUSTRALIA PTY LTD
Homebush – Sydney, Australia
tel. +61 2 87565644
www.faac.com.au

AUSTRIA

FAAC GMBH
Salzburg, Austria
tel. +43 662 85333950
www.faac.at

FAAC BV - TUBULAR MOTORS
Doetinchem, The Netherlands
tel. +49 30 5679 6645
faacbv.info@faacgroup.com
www.faac-tubularmotors.com

BENELUX

FAAC BENELUX NV/SA
Jabbkeke, Belgium
tel. +32 50 320202
info@faacbenelux.com
www.faacbenelux.com

FAAC BV
Doetinchem, The Netherlands
tel. +31 314 369911
faacbv.info@faacgroup.com
www.faacbv.com

BRAZIL

INDÚSTRIAS ROSSI ELETROMECAÂNICA LTDA
Brasilia DF, Brazil
tel. +55 61 33998787
www.rossiportoes.com.br

CHINA

FAAC SHANGHAI
Shanghai, China
tel. +86 21 68182970
www.faacgroup.cn

FRANCE

FAAC FRANCE
Saint Priest - Lyon, France
tel. +33 4 72213020
www.faac.fr

FAAC FRANCE - AGENCE PARIS
Massy - Paris, France
tel. +33 4 72213020
www.faac.fr

FAAC FRANCE - DEPARTEMENT VOLETS
Saint Denis de Pile - Bordeaux, France
tel. +33 5 57551890
www.faac.fr

GERMANY

FAAC GMBH
Freilassing, Germany
tel. +49 8654 49810
www.faac.de

FAAC BV - TUBULAR MOTORS
Doetinchem, The Netherlands
tel. +49 30 5679 6645
faacbv.info@faacgroup.com
www.faac-tubularmotors.com

INDIA

FAAC INDIA
MAGNETIC AUTOCONTROL PVT LTD.
Chennai – India
Tel. +91 44 421 23297
info@magnetic-india.com
www.faac.biz

IRELAND

NATIONAL AUTOMATION LTD
Co. Roscommon, Ireland
tel. +353 71 9663893
www.nal.ie

MIDDLE EAST

FAAC MIDDLE EAST FZE
Dubai Silicon Oasis Operation Center - Dubai, UAE
tel. + 971 4 3724190
www.faac.ae

POLAND

FAAC POLSKA SPZO.O
Warszawa, Poland
tel. +48 22 8141422
fax +48 22 8142024
www.faac.pl

FAAC S.p.A. - Soc. Unipersonale
Via Calari 10 - 40069 Zola Predosa (BO)
Tel. +39 051 61724 - Fax +39 051 0957820
it.info@faacgroup.com

RUSSIA

FAAC RUSSIA
Moscow, Russia
tel. +7 (495) 646 24 29
www.faac.ru

SCANDINAVIA

FAAC NORDIC AB
Perstorp, Sweden
tel. +46 435 779500
www.faac.se

SOUTH AFRICA

CENTURION SYSTEMS PTY LTD
2162 Johannesburg
tel. +27 11 699 2400
www.centsys.co.za

SPAIN

CLEM, S.A.U.
San Sebastián de los Reyes - Madrid, Spain
tel. +34 91 3581110
www.faac.es

SWITZERLAND

FAAC AG
Altdorf, Switzerland
tel. +41 41 8713440
www.faac.ch

TURKEY

FAAC OTOMATİK GEÇİŞ SİSTEMLERİ
SAN. VE TİC. LTD. SİRKETİ
İstanbul, Turkey
tel. +90 (0)212 - 3431311
www.faac.com.tr

UNITED KINGDOM

FAAC UK LTD.
Basingstoke Hampshire, UK
tel. +44 1256 318100
www.faac.co.uk

U.S.A.

FAAC INTERNATIONAL INC
Rockledge, FL - U.S.A.
tel. +1 866 925 3222
www.faacusa.com

FAAC INTERNATIONAL INC
Fullerton, California - U.S.A.
tel. +1 714 446 9800
www.faacusa.com

FAAC
Simply automatic.